

**DIN 965**  
**Cross Recessed Flat Countersunk Machine Screw**

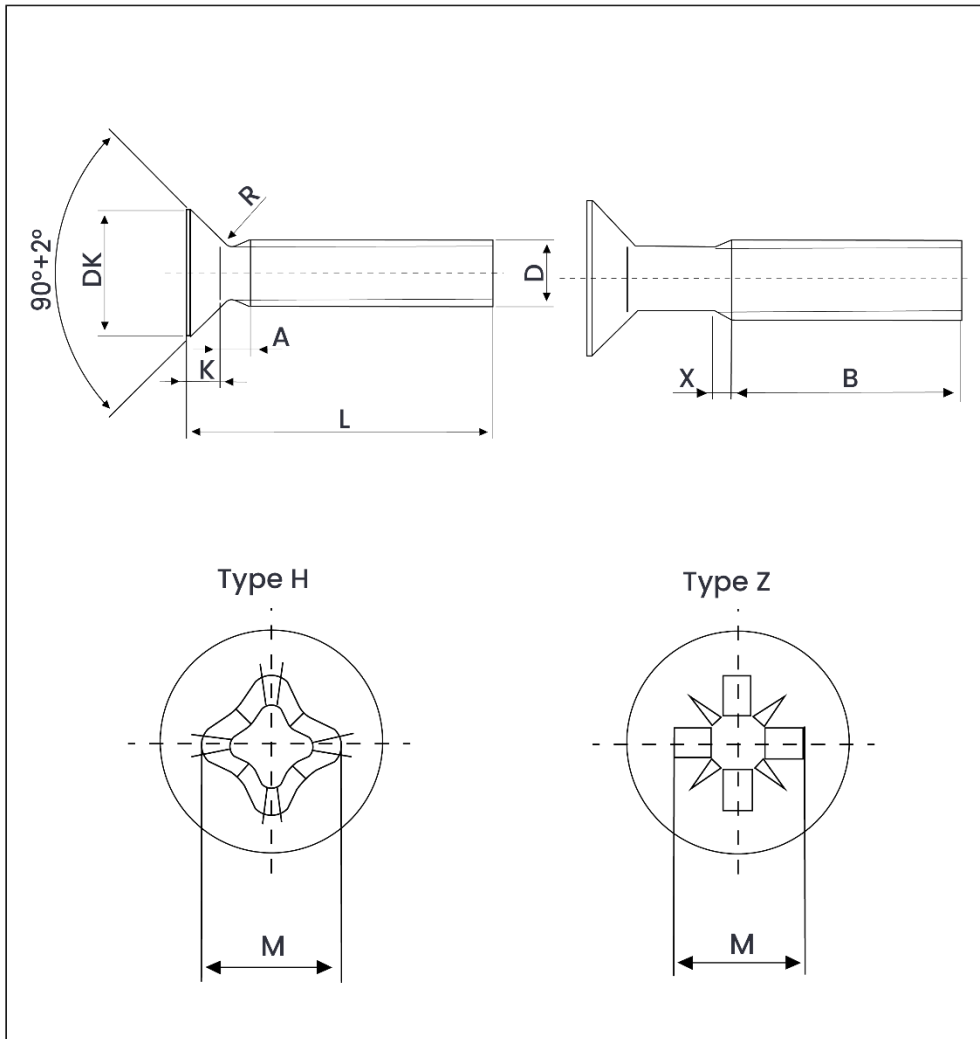

*Weight Chart – DIN 965 Cross Recessed Flat Countersunk Machine Screw*

Weight in Kg/1000 pieces

Table 1: Weight Chart – M1.60 to M3.50

L			M1.60	M2	M2.50	M3	M3.50
Nominal	Min.	Max.					
3	2.80	3.20	0.058	0.101	0.175		
4	3.75	4.25	0.069	0.119	0.206	0.291	0.434
5	4.75	5.25	0.081	0.137	0.236	0.335	0.494
6	5.75	6.25	0.093	0.152	0.266	0.379	0.554
8	7.70	8.30	0.116	0.193	0.326	0.467	0.673
10	9.70	10.30	0.139	0.231	0.386	0.555	0.792
12	11.65	12.35	0.162	0.268	0.446	0.643	0.911
14	13.65	14.35	0.185	0.306	0.507	0.731	1.03
16	15.65	16.35	0.208	0.343	0.567	0.82	1.15
18	17.65	18.35		0.381	0.627	0.908	1.27
20	19.60	20.40		0.417	0.687	0.996	1.39
22	21.60	22.40			0.747	1.08	1.51
25	24.60	25.40			0.838	1.22	1.69
28	27.60	28.40				1.35	1.87
30	29.60	30.40				1.44	1.99
35	34.50	35.50					2.29

Table 2: Weight Chart – M4 to M10

L			M4	M5	M6	M8	M10
Nominal	Min.	Max.					
5	4.75	5.25	0.676				
6	5.75	6.25	0.754	1.21			
8	7.70	8.30	0.90	1.45	2.19		
10	9.70	10.30	1.06	1.70	2.54	5.03	
12	11.65	12.35	1.22	1.95	2.89	5.67	9.59
14	13.65	14.35	1.37	2.19	3.25	6.30	10.60
16	15.65	16.35	1.53	2.44	3.61	6.94	11.60
18	17.65	18.35	1.68	2.69	3.95	7.57	12.60
20	19.60	20.40	1.84	2.94	4.31	8.21	13.60
22	21.60	22.40	1.99	3.18	4.66	8.84	14.60
25	24.60	25.40	2.22	3.55	5.19	9.79	16.10
28	27.60	28.40	2.46	3.93	5.72	10.70	17.60
30	29.60	30.40	2.61	4.16	6.08	11.70	18.60
35	34.50	35.50	2.99	4.76	6.96	13	21.10
40	39.50	40.50	3.36	5.39	7.84	14.60	23.60
45	44.50	45.50		6.02	8.73	16.20	26.10
50	49.50	50.50		6.65	9.61	17.80	28.60
55	54	56				19.40	31.10
60	59	61					33.70